



EAGLE IMPACT LINER PANELS

**AMERICAN
EAGLE
MANUFACTURING LLC**

Modular Chute Wear Liners

Impact panels are molded urethane with Carbide, Ceramic and UHMW particles for direct impact of materials. The Carbide and Ceramic gives you a superior wear surface while the UHMW particles aid in a non-stick surface. The particles are homogeneously mixed with abrasion resistant urethane that also results in impact absorption along with sound and vibration dampening.

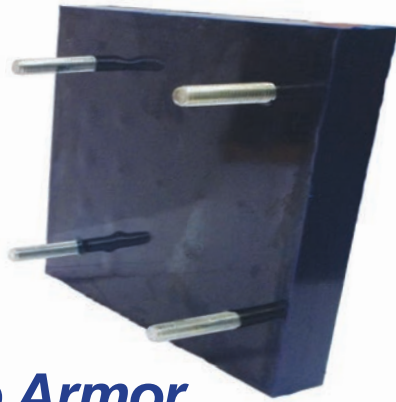

Eagle Armor

*Note: We offer custom sizes upon request.
We ask that you supply a sketch or a drawing.
See our worksheet.*

MOUNTING OPTIONS ARE AVAILABLE FOR IMPACT LINER PANELS: THREADED STUDS / BOLT DOWN

THREADED STUD mounting option

1" Overall thickness

Eagle Impact Liner Panel

Size	Item Number
12X12	EILP-10-1212-TS
12X18	EILP-10-1218-TS
12X24	EILP-10-1224-TS
12X48	EILP-10-1248-TS
18X18	EILP-10-1818-TS
18X24	EILP-10-1824-TS
18X48	EILP-10-1848-TS
24X24	EILP-10-2424-TS
24X48	EILP-10-2448-TS

1-1/2" Overall thickness

Eagle Impact Liner Panel

Size	Item Number
12X12	EILP-15-1212-TS
12X18	EILP-15-1218-TS
12X24	EILP-15-1224-TS
12X48	EILP-15-1248-TS
18X18	EILP-15-1818-TS
18X24	EILP-15-1824-TS
18X48	EILP-15-1848-TS
24X24	EILP-15-2424-TS
24X48	EILP-15-2448-TS

2" Overall thickness

Eagle Impact Liner Panel

Size	Item Number
12X12	EILP-20-1212-TS
12X18	EILP-20-1218-TS
12X24	EILP-20-1224-TS
12X48	EILP-20-1248-TS
18X18	EILP-20-1818-TS
18X24	EILP-20-1824-TS
18X48	EILP-20-1848-TS
24X24	EILP-20-2424-TS
24X48	EILP-20-2448-TS

Threaded Stud

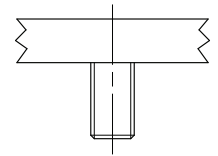

BOLT DOWN mounting option (expanded metal backing)

1" Overall thickness

Eagle Impact Liner Panel

Size	Item Number
12X12	EILP-10-1212-BD
12X18	EILP-10-1218-BD
12X24	EILP-10-1224-BD
12X48	EILP-10-1248-BD
18X18	EILP-10-1818-BD
18X24	EILP-10-1824-BD
18X48	EILP-10-1848-BD
24X24	EILP-10-2424-BD
24X48	EILP-10-2448-BD

1-1/2" Overall thickness

Eagle Impact Liner Panel

Size	Item Number
12X12	EILP-15-1212-BD
12X18	EILP-15-1218-BD
12X24	EILP-15-1224-BD
12X48	EILP-15-1248-BD
18X18	EILP-15-1818-BD
18X24	EILP-15-1824-BD
18X48	EILP-15-1848-BD
24X24	EILP-15-2424-BD
24X48	EILP-15-2448-BD

2" Overall thickness

Eagle Impact Liner Panel

Size	Item Number
12X12	EILP-20-1212-BD
12X18	EILP-20-1218-BD
12X24	EILP-20-1224-BD
12X48	EILP-20-1248-BD
18X18	EILP-20-1818-BD
18X24	EILP-20-1824-BD
18X48	EILP-20-1848-BD
24X24	EILP-20-2424-BD
24X48	EILP-20-2448-BD

Bolt Down

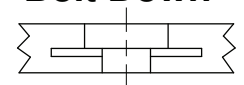



EAGLE IMPACT LINER PANEL WORKSHEET

Company/Plant _____

Address _____

Contact Person _____

Phone _____ Email _____

Contact Person _____

Phone _____ Email _____

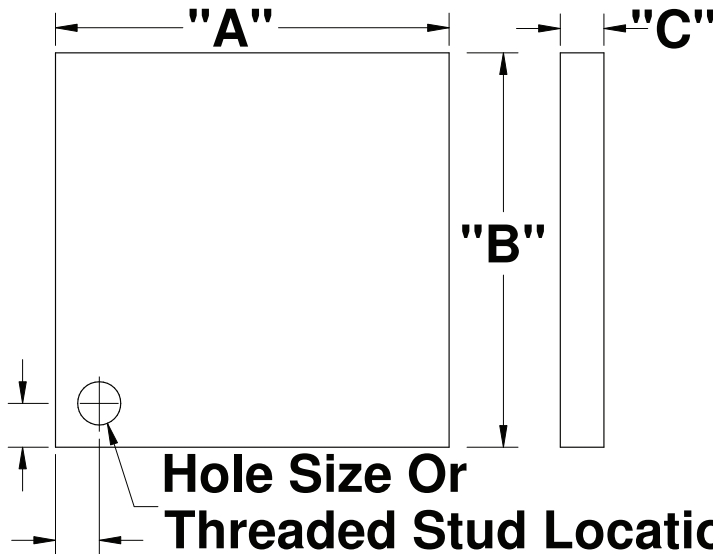

Quantity: _____

"A" = Width _____

"B" = Length _____

"C" = Thickness _____

Bolt Down

How many holes? _____
 What size bolt? _____
 Sketch hole location on print? _____

Threaded Stud

How many threaded studs? _____
 What size threaded stud? _____
 What length threaded stud? _____
 Sketch stud location on print? _____

1211 Aviation Dr., New Bern, North Carolina 28562
 Phone: 252-633-0603 Toll Free: 866-713-8985 Fax: 252-633-5487
www.AmericanEagleManufacturing.com

